

Ophthalmic Surgery Chair [DR-150]

MEPRO V



For More Optimal Surgical Position.

The Chair-type Ophthalmic Operating Table MEPRO Series Has Evolved Along with the Development of Ophthalmic Surgery.

This chair-type ophthalmic operating table is designed to make it easy for doctors, staff, and patients to get on and off the table and maintain their posture during surgery in the ever-evolving field of ophthalmic surgery.



Reclining Mechanism that Makes It Easy for the Patient to Sit and for the Doctor to Perform the Procedure

A chair-type operating table with the lowest position of 485 mm for patient's sitting comfort. Converts to surgical position with a push of a programmable setting switch (PRESET switch). The height can also be adjusted within the 285 mm lifting stroke range. After surgery, the patient can be smoothly converted to a chair position with a single push of the programmable return switch(AUTO RETURN switch). Smooth and quiet operation due to hydraulic mechanism.

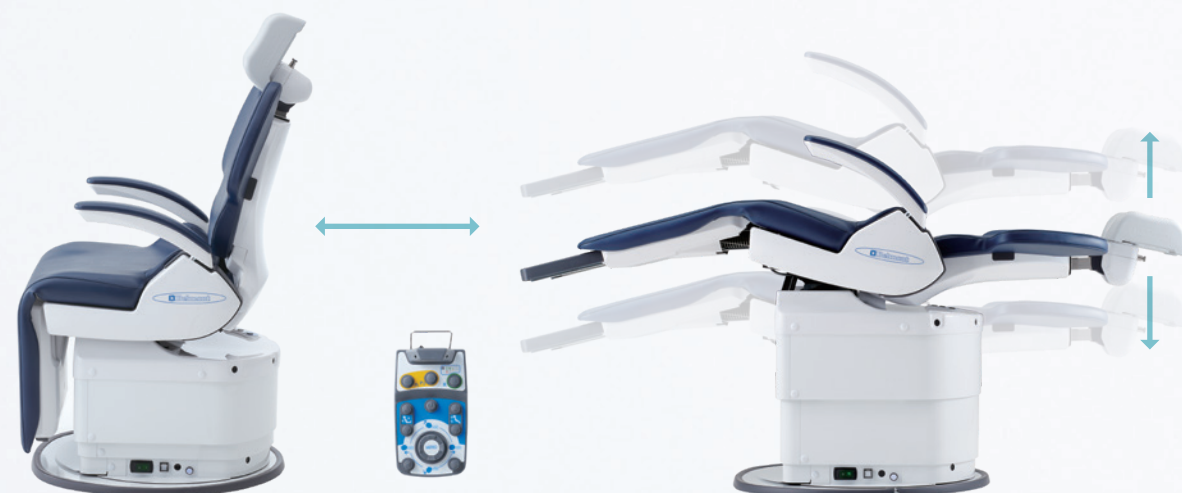

Sliding Mechanism for Headrests to Absorb Differences in Patient Height

The headrest can be extended and retracted by foot control operation to absorb differences in patient height.



Reclining and Headrest Interlocking Mechanism to Prevent Patient's Head from Moving Out of the Headrest.

During auto operation, the headrest is retracted in conjunction with reclining, preventing the head from moving out of the headrest and reducing the frequency of patient position correction. In addition, the recline is driven at low speed during manual control, allowing for fine adjustment.



Split Left and Right Headrests to Hold the Head Firmly in Place

Cushions are shaped like both hands holding a head. By supporting both sides of a head, it is possible to hold a head securely.



Headrest Elevation Mechanism to Accommodate Patients with Round Backs

Equipped with a 2-stage (25 mm, 50 mm) elevation mechanism for patients with mild round back (manual operation).



Chair-type Operating Table Provides Ample Room for Doctor's Legs

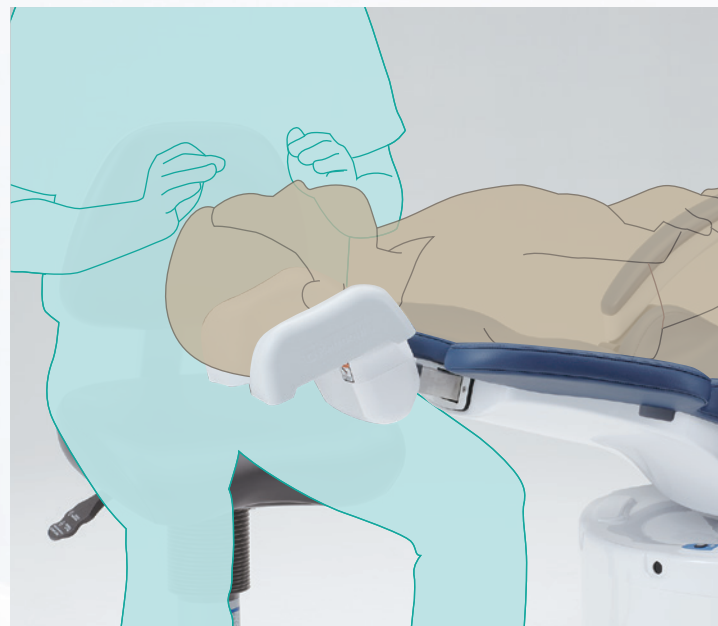

The chair-type operating table with casters stored inside the main body allows for more leg room for the doctor.

In addition, MEPRO 5 has a motorized headrest elevation and tilt mechanism, making the backrest and headrest thinner than our previous products. This further reduces knee interference during the procedure. The slim and flat backrest provides a more comfortable surgical posture.

MEPRO 5

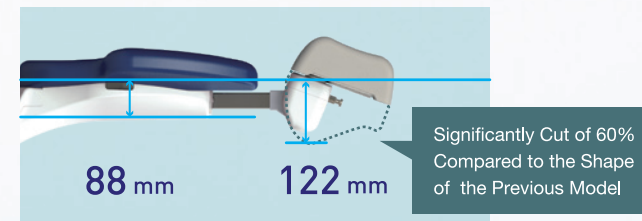

Layout Can Be Changed More Efficiently for Surgery on Either the Left or Right Eye.

Equipped with an axis rotation mechanism, layout changes can be made more smoothly according to the positioning of the left and right eye.

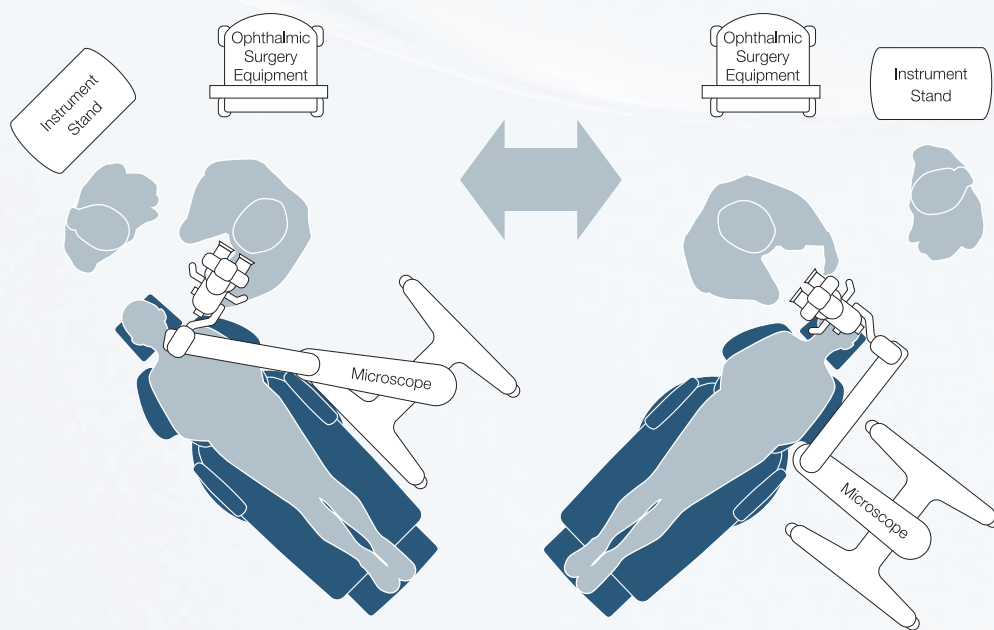

90-degree Left/Right Rotation Range

When unlocked, the table can rotate around the elevation mechanism (Manual operation). Rotation can be locked at any position within the range.

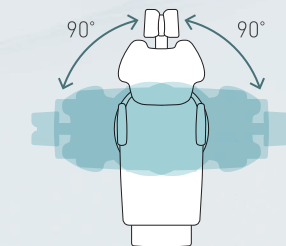

Rotation Release/Lock Switch

Each press of the switch repeatedly locks and unlocks the rotating mechanism.

The Vertical Design and Cordless Mechanism Make the Doctor's Feet More Neat and Tidy.

The vertical foot control makes it easy to use alongside peripheral foot controls. The wireless design also allows the doctor's leg workspace to remain more spacious and organized.

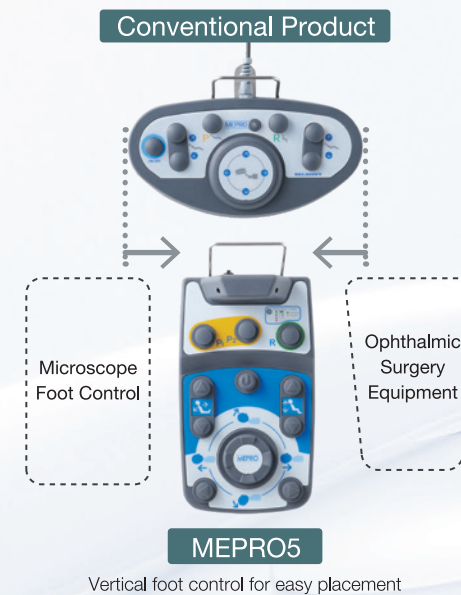

Rechargeable Foot Control

The foot control is rechargeable; one charge provides approximately 40 days of use (when new). When the battery charge is low, the remaining battery charge indicator lamp informs the user of the remaining charge level in four levels. Even in the unlikely event that the battery charge runs out, it can be used as a wired foot control by connecting the connection cable. Connecting the cable starts charging the foot control (the connecting cable can be stored on the back of the foot control).



Preset Switch

Two presets for two positions are provided, so the system can be set up for effective use in accordance with the operating room, such as setting up positions for multiple doctors or for the standing position (e.g., preoperative eye-wash position).

Backrest Movement Switch

Headrest Operation Switch

Power Switch

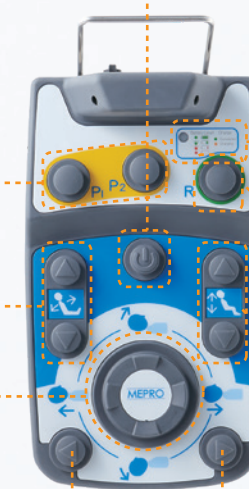

Battery Level Indicator Lamp



The lamp lights up (blinks) when the switch is operated to inform the user of the remaining battery level.

Auto-Return Switch

Table Elevation Switch

Auxiliary Switch (Table will not actuate when pressed)

Swivel Retractable Armrests (180° Rotation for Both Sides)

Swivel and retractable armrests (both sides) for convenient patient transfers from wheelchairs and stretchers. Cushioned to protect the patient's arm.

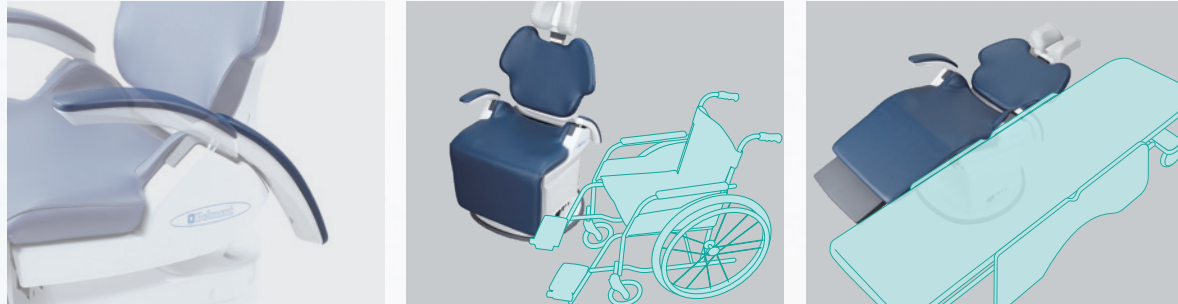

Electric Elevating Casters for Convenient Mobility

Pressing the switch activates the built-in mobile casters to lift the chair. 4-wheeled swivel casters allow movement in all directions. Layout changes and room-to-room transfers can be easily made.

Table Lock Switch

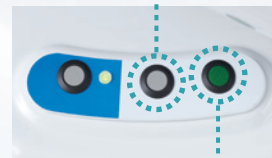

Table Move Switch



Swivel Mobile Casters



Accessories

Accessory parts that support surgery.

Wrist Rest [DR-150R]



The wrist rest is designed to work with the Headrest Elevation Mechanism for mild round-back patients, reducing the need for height adjustment. (Compared to the previous product)

Upper-limb Rest [DR-150AM]



Because it is attached to the side rail, it can be adjusted to accommodate the patient's physical differences.

Color Selection



ES23
Aldo Blue
[Standard Color]

ES2
Yellow

ES7
Ocean Blue

ES8
Black

ES10
Light Brown

ES15
Light Green

ES16
Purple Blue

Specifications

Lifting and Lowering the Chair	485-770 mm by Electrohydraulic System
Backrest Angle Range	0-80° by Electrohydraulic System
Extending and Retracting the Headrest	170 mm by Electromotor System
Bending Forward and Backward the Headrest	35° by Electromotor System
Electrical Rating	AC 110/120/220/230/240 V, 50/60 Hz
Product Weight	155.6 kg

Repair and Emergency Response

[Display Error Details]



In the unlikely event that a malfunction occurs, the details of the error will be digitally displayed on the side of the main unit, allowing for smoother repairs.

[Equipped with Emergency Operation Mode Switch]



Equipped with an emergency operation mode switch on the main body. Even if the position detection sensor of each operating part fails, manual control is possible using the emergency operation mode.

